

REVISION D 31/12/09

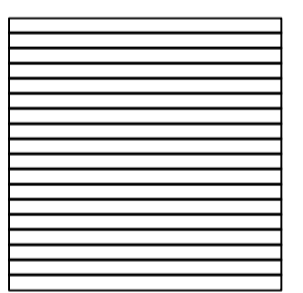
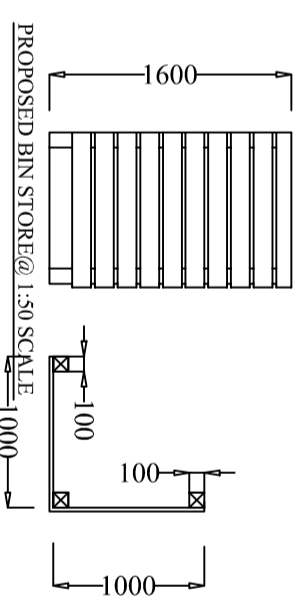
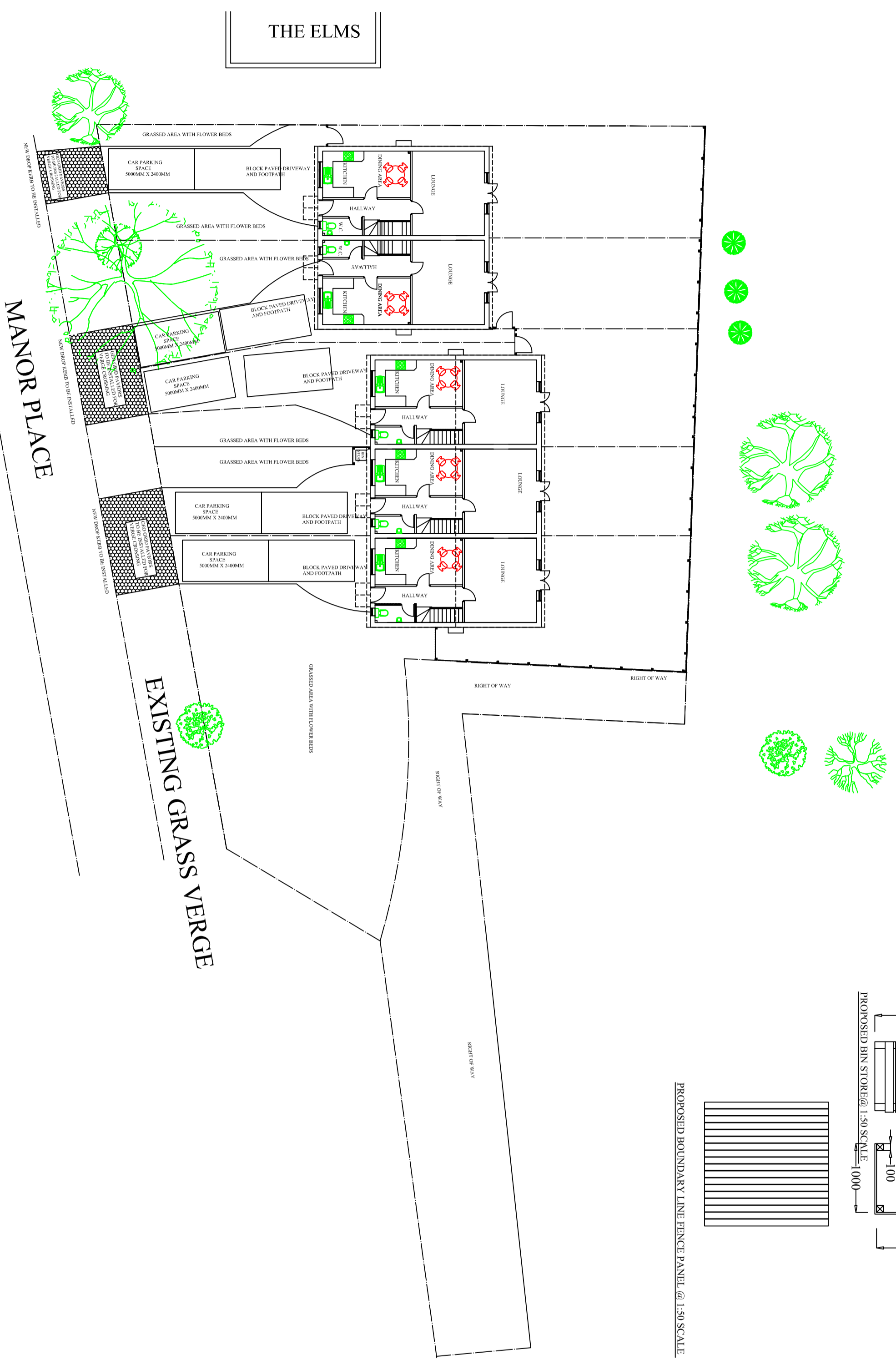

THE PLANMAN OWNS THE COPYRIGHT OF THIS DRAWING. UNAUTHORISED, PARTIAL OR COMPLETE REPRODUCTION OF THIS DRAWING IN EITHER 2 OR 3 DIMENSIONAL FORM MAY RESULT IN LEGAL ACTION BEING TAKEN.

CLIENT:
MR M BUTTERY & MR D BUTTERY

ADDRESS:
118 THE STABLES
WYNYARD PARK
BILLINGHAM
TS22 5QY

SITE ADDRESS:
118 THE STABLES
NOT MANOR PLACE
OFF BISHOPTON ROAD WEST
STOCKTON ON TEES

LOCAL AUTHORITY:
STOCKTON ON TEES BOROUGH COUNCIL
TECHNICAL SERVICES DEPARTMENT
PLANNING DIVISION
GLUCESLER HOUSE
STOCKTON ROAD
STOCKTON ON TEES
TS16 1TW

WIDTH OF PROPOSED DEVELOPMENT: 26180MM
PROJECTION OF PROPOSED DEVELOPMENT: 12959MM
EAVES HEIGHT OF PROPOSED DEVELOPMENT: 4950MM
OVERALL HEIGHT OF PROPOSED DWELLINGS: 7950MM
ROOF PITCH 30°

AGENT:
STUART PINCHES
THE PLANMAN
8 DRYDEN CLOSE
BILLINGHAM
STOCKTON ON TEES
TS23 3JT
01642 874906
spinch@stuartpinches.com

DRAWING NO.: 4 OF 4
DATE: 03/09/09
SCALE: 1:200