

Appendix E
PROPOSED ENTRANCE LEVEL PLAN

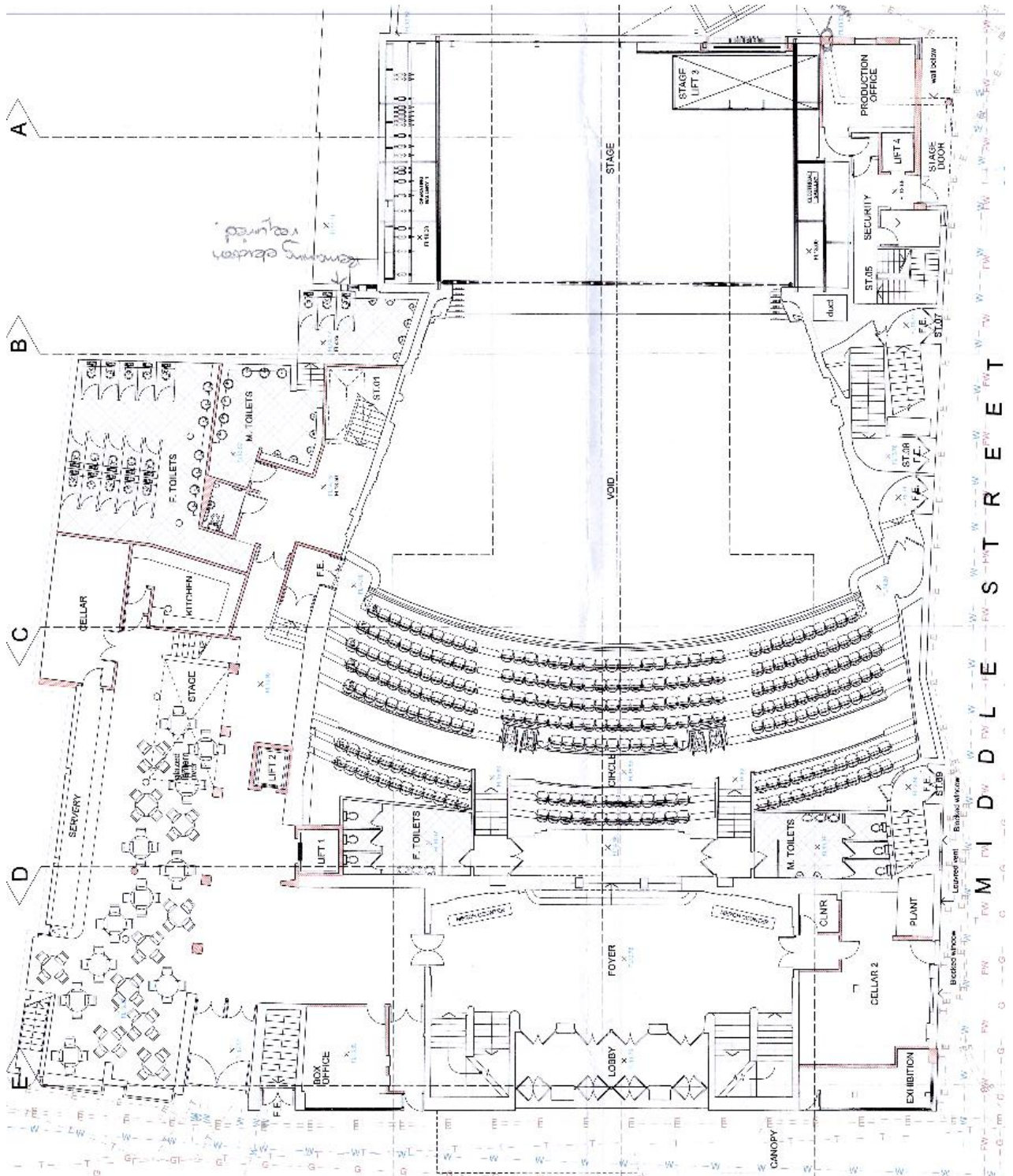

Listed Building Consent for the restoration and refurbishment of The Globe with new back-of-house facilities to create a performance and multi-purpose venue and change of use of No. 153 High Street to bar/bistro plus toilets and administrative offices to support The Globe and to function as an occasional stand-alone unit (Application 17/0755/LBC)