

STOCKTON CUSTOMER SERVICES
RECEIVED

06 JUL 2017

JA

LICENSING
- 6 JUL 2017
RECEIVED
Community Safety
Appendix 1

Big plans for keeping our communities safe

Application to Vary a Premises Licence under the Licensing Act 2003

PLEASE READ THE FOLLOWING INSTRUCTIONS FIRST

Before completing this form please read the guidance notes at the end of the form. If you are completing this form by hand please write legibly in block capitals. In all cases ensure that your answers are inside the boxes and written in black ink. Use additional sheets if necessary.

You may wish to keep a copy of the completed form for your records.

I/We SHAUN THOMAS CRAVE
(Insert name(s) of applicant)

being the premises licence holder, apply to vary a premises licence under section 34 of the Licensing Act 2003 for the premises described in Part 1 below

Premises licence number	144191
-------------------------	--------

Part 1 – Premises Details THREE RIVERS INGLEBY BARWICK LTD.

Postal address of premises or, if none, ordnance survey map reference or description <u>9 SANDGATE PARK, SHOPPING CENTRE. BANCROFT DRIVE, INGLEBY BARWICK STOCKTON TS17 5AA</u>			
Post town	<u>STOCKTON</u>	Postcode	<u>TS17 5AA</u>

Telephone number at premises (if any)	<u>07789277364</u>
Non-domestic rateable value of premises	<u>£ 4300</u>

Part 2 – Applicant details

Daytime contact telephone number	<u>SHAUN CRAVE 07789 277364</u>		
E-mail address (optional)	<u>shaun.crave@networld.com</u>		
Current postal address if different from premises address	<u>SAME.</u>		
Post town		Postcode	

Part 3 - Variation

Please tick as appropriate

Do you want the proposed variation to have effect as soon as possible?

Yes

No

If not, from what date do you want the variation to take effect?

DD		MM		YYYY			
1	1	1	1	1	1	1	1

Do you want the proposed variation to have effect in relation to the introduction of the late night levy? (Please see guidance note 1) Yes No

Please describe briefly the nature of the proposed variation (Please see guidance note 2)

REDUCE RECORDING/LIVE MUSIC & SUPPLY OF ALCOHOL TIME TO 23-30
INCREASE OFF SALES TO 23-30 TO MATCH ABOVE TIMES.

OPENING HOURS TO STAY AT 24-00 HRS.

ENCLOSED NEW PLAN SHOWING OUTSIDE SEATING AREAS 1 + 2.

1 TILL 21-00 HRS
2 TILL 23-00 HRS.

If your proposed variation would mean that 5,000 or more people are expected to attend the premises at any one time, please state the number expected to attend:

Part 4 Operating Schedule

Please complete those parts of the Operating Schedule below which would be subject to change if this application to vary is successful.

Provision of regulated entertainment (Please see guidance note 3)

Please tick all that apply

- a) plays (if ticking yes, fill in box A)
- b) films (if ticking yes, fill in box B)
- c) indoor sporting events (if ticking yes, fill in box C)
- d) boxing or wrestling entertainment (if ticking yes, fill in box D)
- e) live music (if ticking yes, fill in box E)
- f) recorded music (if ticking yes, fill in box F)
- g) performances of dance (if ticking yes, fill in box G)
- h) anything of a similar description to that falling within (e), (f) or (g) (if ticking yes, fill in box H)

Provision of late night refreshment (if ticking yes, fill in box I)

Supply of alcohol (if ticking yes, fill in box J)

In all cases complete boxes K, L and M

A

Plays Standard days and timings (please read guidance note 8)			<u>Will the performance of a play take place indoors or outdoors or both – please tick (please read guidance note 4)</u>	Indoors	<input type="checkbox"/>
				Outdoors	<input type="checkbox"/>
				Both	<input type="checkbox"/>
Day	Start	Finish	<u>Please give further details here (please read guidance note 5)</u>		
Mon					
			<u>State any seasonal variations for performing plays (please read guidance note 6)</u>		
Tue					
			<u>Non standard timings. Where you intend to use the premises for the performance of plays at different times to those listed in the column on the left, please list (please read guidance note 7)</u>		
Wed					
Thur					
Fri					
Sat					
Sun					

B

Films Standard days and timings (please read guidance note 8)			<u>Will the exhibition of films take place indoors or outdoors or both – please tick (please read guidance note 4)</u>	Indoors	<input type="checkbox"/>
				Outdoors	<input type="checkbox"/>
				Both	<input type="checkbox"/>
Day	Start	Finish	<u>Please give further details here (please read guidance note 5)</u>		
Mon					
Tue			<u>State any seasonal variations for the exhibition of films (please read guidance note 6)</u>		
Wed					
Thur			<u>Non standard timings. Where you intend to use the premises for the exhibition of films at different times to those listed in the column on the left, please list (please read guidance note 7)</u>		
Fri					
Sat					
Sun					

C

Indoor sporting events Standard days and timings (please read guidance note 8)			<u>Please give further details</u> (please read guidance note 5)	
Day	Start	Finish		
Mon			<u>State any seasonal variations for indoor sporting events</u> (please read guidance note 6)	
Tue				
Wed				<u>Non standard timings. Where you intend to use the premises for indoor sporting events at different times to those listed in the column on the left, please list</u> (please read guidance note 7)
Thur				
Fri				
Sat				
Sun				

D

Boxing or wrestling entertainments Standard days and timings (please read guidance note 8)			<u>Will the boxing or wrestling entertainment take place indoors or outdoors or both – please tick</u> (please read guidance note 4)	Indoors	<input type="checkbox"/>
				Outdoors	<input type="checkbox"/>
				Both	<input type="checkbox"/>
Day	Start	Finish	<u>Please give further details here (please read guidance note 5)</u>		
Mon					
Tue			<u>State any seasonal variations for boxing or wrestling entertainment</u> (please read guidance note 6)		
Wed					
Thur			<u>Non standard timings. Where you intend to use the premises for boxing or wrestling entertainment at different times to those listed in the column on the left, please list (please read guidance note 7)</u>		
Fri					
Sat					
Sun					

E

Live music Standard days and timings (please read guidance note 8)			Will the performance of live music take place indoors or outdoors or both – please tick (please read guidance note 4)	Indoors	<input checked="" type="checkbox"/>			
				Outdoors	<input type="checkbox"/>			
				Both	<input checked="" type="checkbox"/>			
Day	Start	Finish	Please give further details here (please read guidance note 5)					
Mon	11-00	23-30						
Tue	11-00	23-30						
Wed	11-00	23-30				State any seasonal variations for the performance of live music (please read guidance note 6)		
Thur	11-00	23-30						
			Non standard timings. Where you intend to use the premises for the performance of live music at different times to those listed in the column on the left, please list (please read guidance note 7)					
Fri	11-00	23-30						
Sat	11-00	23-30						
Sun	11-00	23-30						

F

Recorded music Standard days and timings (please read guidance note 8)			Will the playing of recorded music take place indoors or outdoors or both – please tick (please read guidance note 4)	Indoors	<input type="checkbox"/>
				Outdoors	<input type="checkbox"/>
				Both	<input checked="" type="checkbox"/>
Day	Start	Finish			
Mon	9-00	23-30	<u>Please give further details here</u> (please read guidance note 5)		
Tue	9-00	23-30			
Wed	9-00	23-30	<u>State any seasonal variations for the playing of recorded music</u> (please read guidance note 6)		
Thur	9-00	23-30			
Fri	9-00	23-30	<u>Non standard timings. Where you intend to use the premises for the playing of recorded music at different times to those listed in the column on the left, please list</u> (please read guidance note 7)		
Sat	9-00	23-30			
Sun	9-00	23-30			

G

Performances of dance Standard days and timings (please read guidance note 8)			Will the performance of dance take place indoors or outdoors or both – please tick (please read guidance note 4)	Indoors	<input type="checkbox"/>
Day	Start	Finish		Outdoors	<input type="checkbox"/>
				Both	<input type="checkbox"/>
Mon			Please give further details here (please read guidance note 5)		
Tue					
Wed			State any seasonal variations for the performance of dance (please read guidance note 6)		
Thur					
Fri			Non standard timings. Where you intend to use the premises for the performance of dance at different times to those listed in the column on the left, please list (please read guidance note 7)		
Sat					
Sun					

H

Anything of a similar description to that falling within (e), (f) or (g) Standard days and timings (please read guidance note 8)			Please give a description of the type of entertainment you will be providing		
Day	Start	Finish	<u>Will this entertainment take place indoors or outdoors or both – please tick</u> (please read guidance note 4)	Indoors	<input type="checkbox"/>
Mon				Outdoors	<input type="checkbox"/>
				Both	<input type="checkbox"/>
Tue			<u>Please give further details here</u> (please read guidance note 5)		
Wed					
Thur			<u>State any seasonal variations for entertainment of a similar description to that falling within (e), (f) or (g)</u> (please read guidance note 6)		
Fri					
Sat			<u>Non standard timings. Where you intend to use the premises for the entertainment of a similar description to that falling within (e), (f) or (g) at different times to those listed in the column on the left, please list</u> (please read guidance note 7)		
Sun					

Late night refreshment Standard days and timings (please read guidance note 8)			Will the provision of late night refreshment take place indoors or outdoors or both – please tick (please read guidance note 4)	Indoors	<input type="checkbox"/>
				Outdoors	<input type="checkbox"/>
				Both	<input type="checkbox"/>
Day	Start	Finish	Please give further details here (please read guidance note 5)		
Mon					
Tue			State any seasonal variations for the provision of late night refreshment (please read guidance note 6)		
Wed					
Thur			Non standard timings. Where you intend to use the premises for the provision of late night refreshment at different times, to those listed in the column on the left, please list (please read guidance note 7)		
Fri					
Sat					
Sun					

J

Supply of alcohol Standard days and timings (please read guidance note 8)			Will the supply of alcohol be for consumption – please tick (please read guidance note 9)	On the premises	<input type="checkbox"/>			
				Off the premises	<input type="checkbox"/>			
				Both	<input checked="" type="checkbox"/>			
Day	Start	Finish	State any seasonal variations for the supply of alcohol (please read guidance note 6)					
Mon	11-00	23.30						
Tue	11-00	23.30						
Wed	11-00	23.30						
Thur	11-00	23.30				Non-standard timings. Where you intend to use the premises for the supply of alcohol at different times to those listed in the column on the left, please list (please read guidance note 7)		
Fri	11-00	23.30						
Sat	11-00	23.30						
Sun	11-00	23.30						

K

Please highlight any adult entertainment or services, activities, other entertainment or matters ancillary to the use of the premises that may give rise to concern in respect of children (please read guidance note 10).

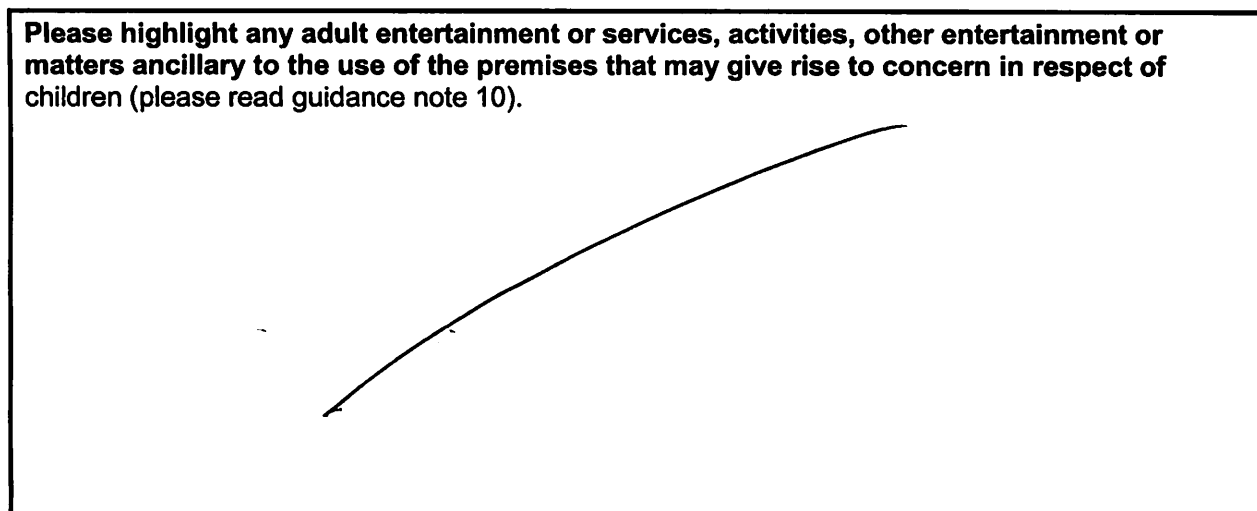

L

Hours premises are open to the public Standard days and timings (please read guidance note 8)			State any seasonal variations (please read guidance note 6)
Day	Start	Finish	
Mon	8-00	24-00	
Tue	8-00	24-00	
Wed	8-00	24-00	
Thur	8-00	24-00	
Fri	8-00	24-00	
Sat	8-00	24-00	
Sun	10-00	24-00	

Non standard timings. Where you intend the premises to be open to the public at different times from those listed in the column on the left, please list (please read guidance note 7)

Please identify those conditions currently imposed on the licence which you believe could be removed as a consequence of the proposed variation you are seeking.

REMOVE
Alcohol shall not be removed from the designated licensed area in open containers

Please tick as appropriate

- I have enclosed the premises licence
- I have enclosed the relevant part of the premises licence

If you have not ticked one of these boxes, please fill in reasons for not including the licence or part of it below

Reasons why I have not enclosed the premises licence or relevant part of premises licence.

Lost during renovations.

M Describe any additional steps you intend to take to promote the four licensing objectives as a result of the proposed variation:

a) General – all four licensing objectives (b, c, d and e) (please read guidance note 11)

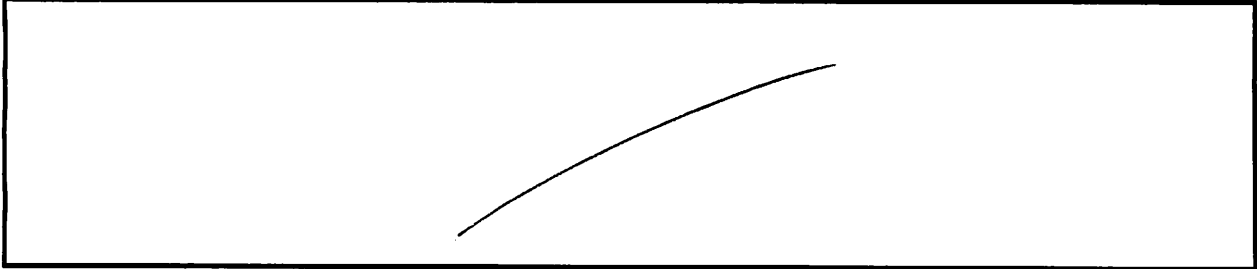

b) The prevention of crime and disorder

Alcohol shall not be removed from the designated seating areas 1+2. As shown on premise licence plan.

c) Public safety

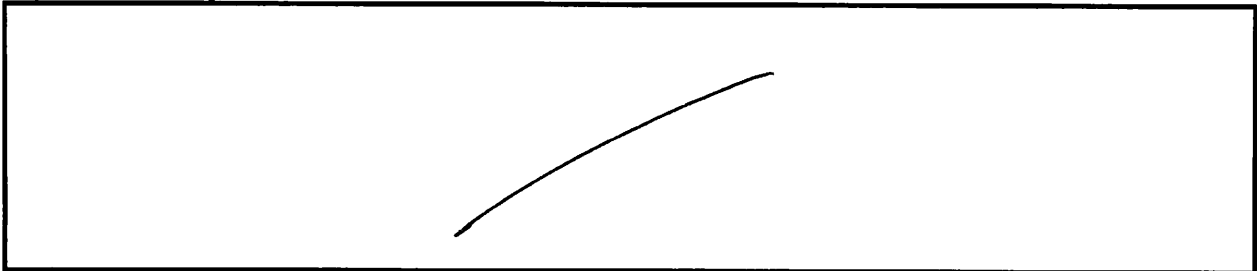

d) The prevention of public nuisance

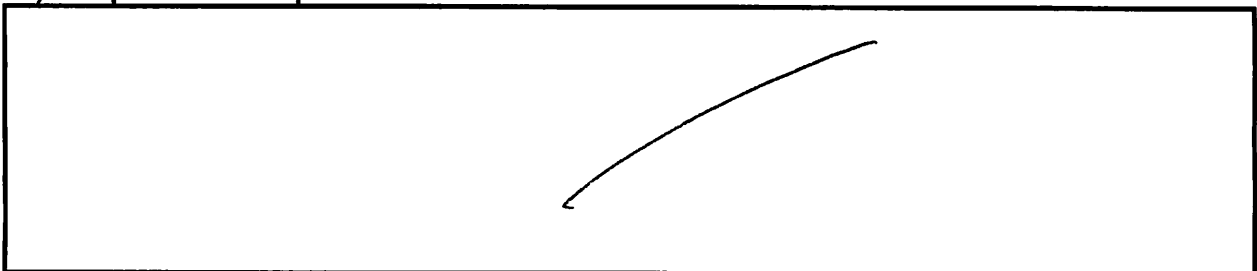

e) The protection of children from harm

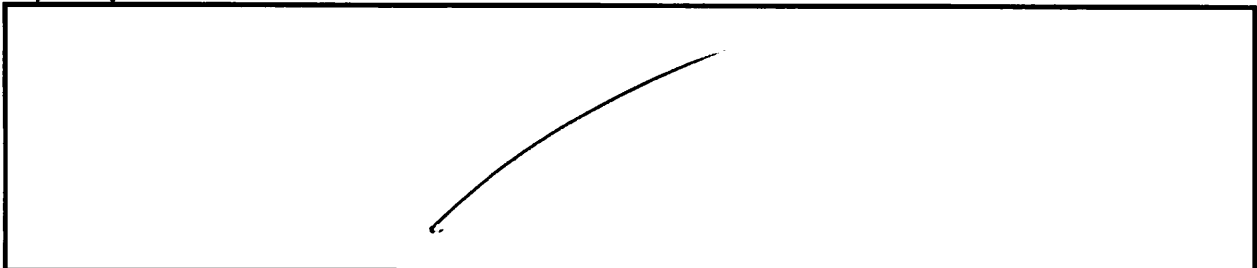

Checklist:

Please tick to indicate agreement

- I have made or enclosed payment of the fee; or
- I have not made or enclosed payment of the fee because this application has been made in relation to the introduction of the late night levy.
- I have sent copies of this application and the plan to responsible authorities and others where applicable.
- I understand that I must now advertise my application.
- I have enclosed the premises licence or relevant part of it or explanation.
- I understand that if I do not comply with the above requirements my application will be rejected.

IT IS AN OFFENCE, UNDER SECTION 158 OF THE LICENSING ACT 2003, TO MAKE A FALSE STATEMENT IN OR IN CONNECTION WITH THIS APPLICATION. THOSE WHO MAKE A FALSE STATEMENT MAY BE LIABLE ON SUMMARY CONVICTION TO A FINE OF ANY AMOUNT.

Part 5 – Signatures (please read guidance note 12)

Signature of applicant (the current premises licence holder) or applicant’s solicitor or other duly authorised agent (please read guidance note 13). If signing on behalf of the applicant, please state in what capacity.

Signature	
Date	6/7/17
Capacity	Director

Where the premises licence is jointly held, signature of 2nd applicant (the current premises licence holder) or 2nd applicant’s solicitor or other authorised agent (please read guidance note 14). If signing on behalf of the applicant, please state in what capacity.

Signature	
Date	
Capacity	

Contact name (where not previously given) and address for correspondence associated with this application (please read guidance note 15)

<p>Contact name (where not previously given) and address for correspondence associated with this application (please read guidance note 15)</p>			
Post town		Post code	
Telephone number (if any)			
If you would prefer us to correspond with you by e-mail, your e-mail address (optional)			

01 PREMISE LICENCE PLAN (VARIATION)
SCALE 1:100 @ A4

Total Planning Solutions
 Town Planning & Architectural Consultancy
 5 Rivers Bar & Coffee Shop
 PROJECT
 11th Floor, 100, Shopping Centre, Bancroft Drive
 Upper Bonhill, B317 5AA
 DRAWN BY: RS/JAL/ML
 DATE: 17/2017
 CHECKED BY: [blank]
 DRAWING NO: TP0501VARIATION1 - Premises License

Copyright
 This document is the property of Total Planning Solutions. It is not to be reproduced, stored in a retrieval system, or transmitted in any form or by any means, electronic, mechanical, photocopying, recording, or by any information storage and retrieval system, without the prior written permission of Total Planning Solutions. The user agrees to indemnify and hold Total Planning Solutions harmless from and against all claims, damages, losses and expenses, including reasonable attorneys' fees, arising out of or from the use of this document.

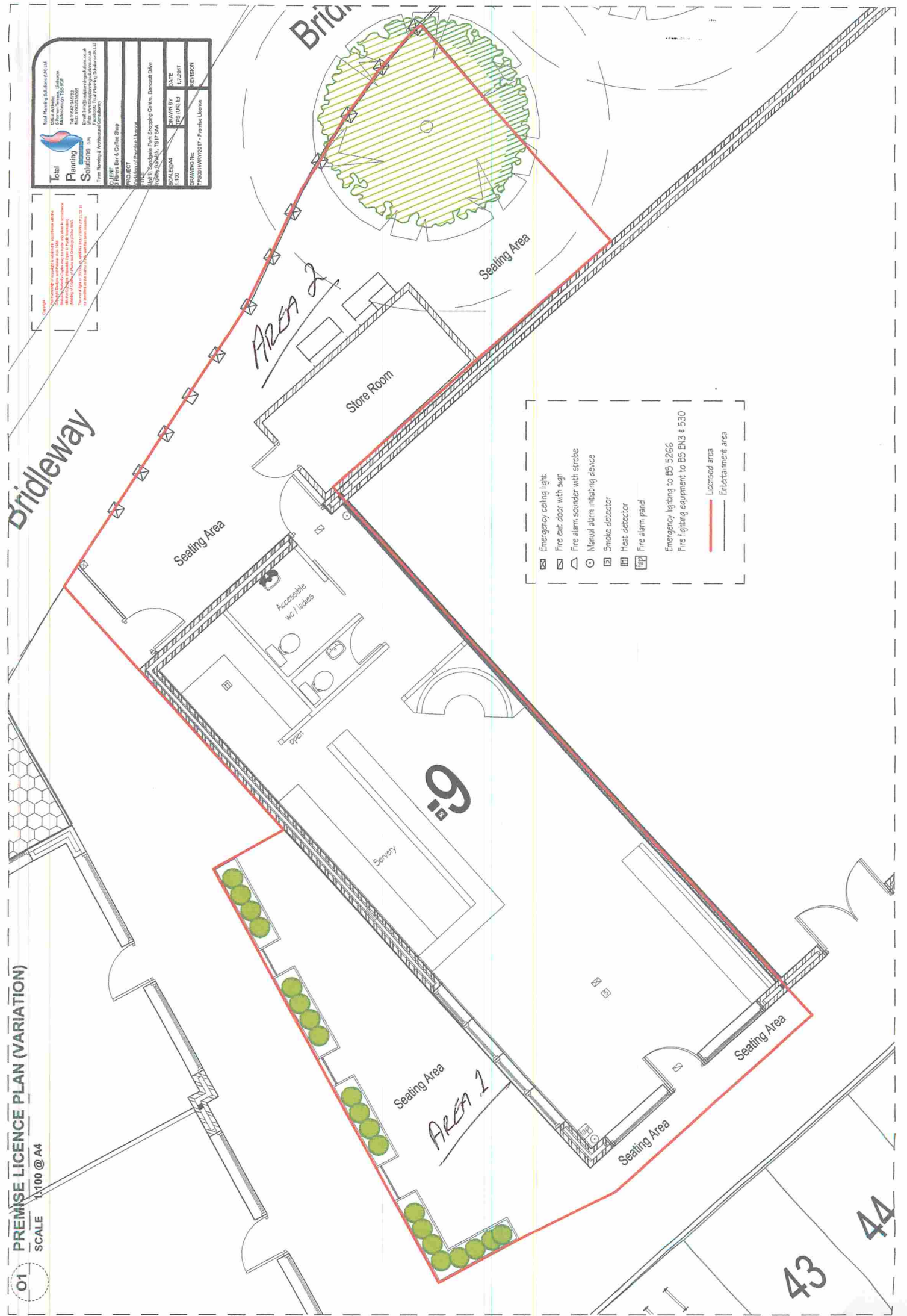

- ☒ Emergency ceiling light
- ☒ Fire exit door with sign
- ☒ Fire alarm sounder with strobe
- ☒ Manual alarm initiating device
- ☒ Smoke detector
- ☒ Heat detector
- ☒ Fire alarm panel
- ☒ Emergency lighting to BS 5266
- ☒ Fire fighting equipment to BS EN3 & 530
- Licensed area
- Entertainment area

43
44