

**GENERAL NOTES, GROUND FLOOR & 1ST FLOOR AREA**

**Floors**

Replace existing Wood Flooring with New concrete floor areas.

Floor Tiles on 50mm. screed on 100mm. concrete base with D.P.C. membrane on 150mm. Hardcore base fill.

**Walls**

- == Existing brick wall divider removed.
- New beams & columns design by Carter Steel Ltd. Stockton.
- Existing & new wall areas to have 15mm. plaster boarding with insulation in stud walls.
- Existing 2 Doors & Window openings bricked up to Rear Ground Floor.

**Ceilings**

Existing, New 2 Layers 15mm. Plaster Boards.  
New Suspended Ceilings to Tea Room/ Main Shop Areas, by approved supplier.

**Doors**

New 1 Hour Fire Doors as noted.

**Electric**

All new wiring through, to meet with new standards and practices.  
Auto Fire/Smoke Alarms to be fitted to rooms as required.

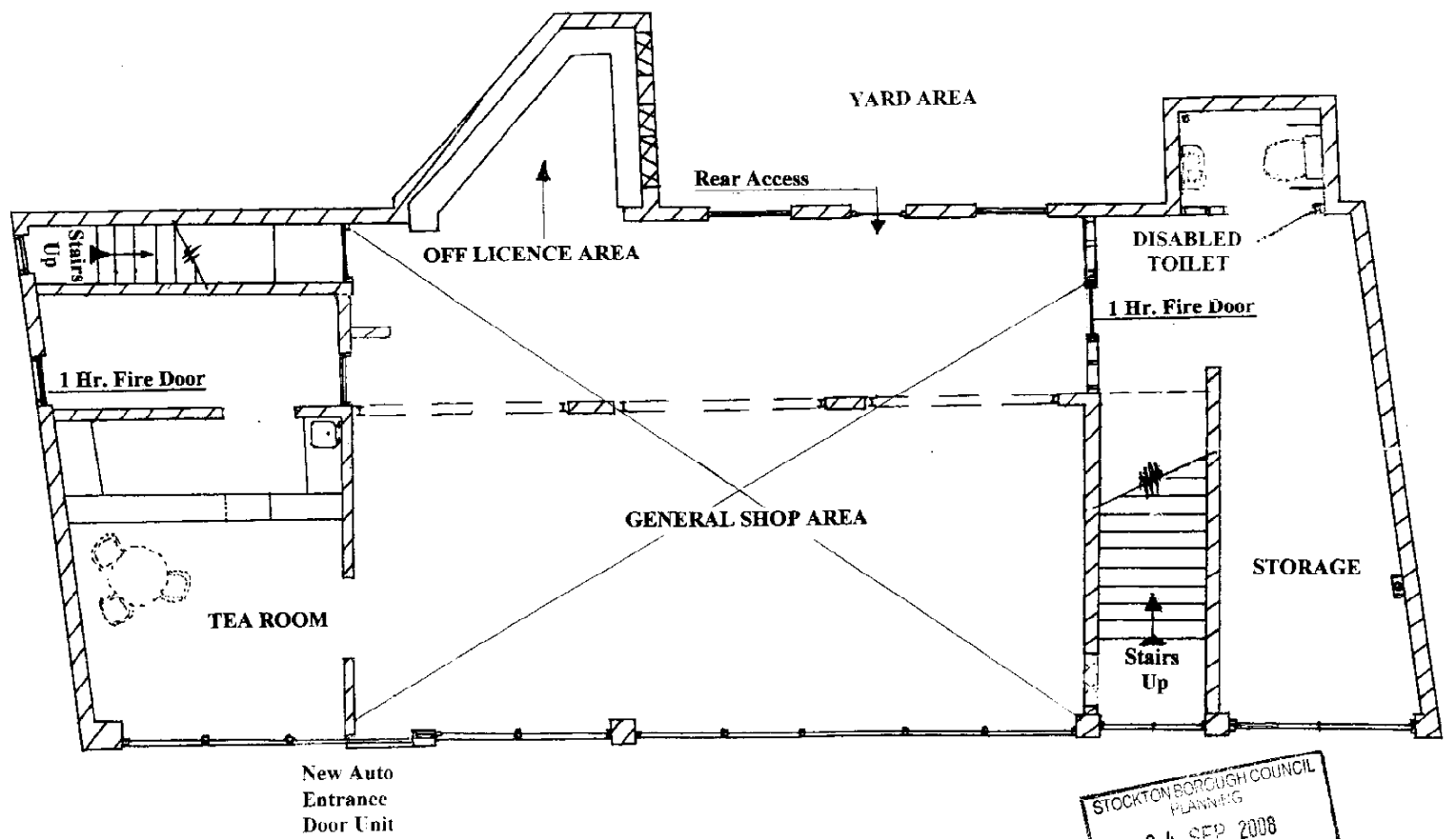

STOCKTON BOROUGH COUNCIL  
PLANNING  
04 SEP 2008  
RECEIVED

**RENOVATION & ALTERATIONS TO  
EXISTING PREMISES AT NORTON HOUSE,  
64/66 LEVEN ROAD, NORTON, STOCKTON**

**PROPOSED GROUND FLOOR PLAN**

Scale: 1/100

Plan No. **3B**